

## SUPPLY AIR VALVE

**SR-SX**

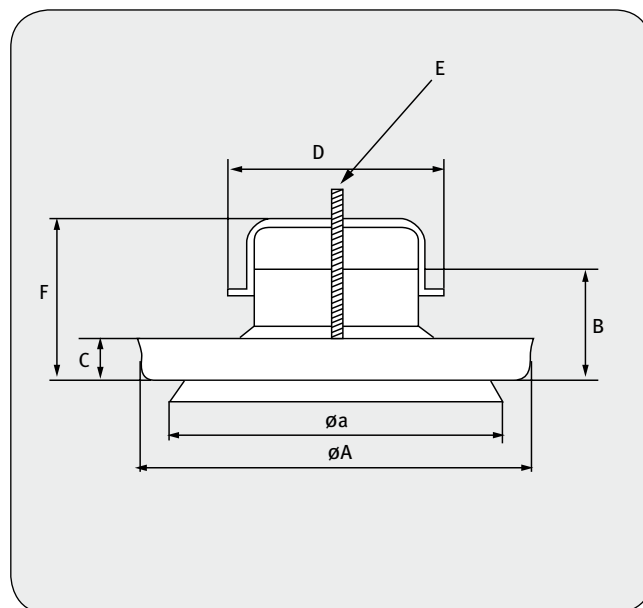

- Supply air valve designed for ceiling mounting on ventilation ducts
- Long mounting frame with gasket makes it easier to connect to ventilation system
- Made of galvanized steel
- Painted white (RAL 9010)
- Easy adjustment of air flow by rotating the central part
- Blocking nut allows for setting the minimum slot
- Special design provides low noise level
- High quality and modern design
- Fast and easy installation

Valve diameter	øA (mm)	B (mm)	C (mm)	E (mm)	øa (mm)	E (mm)	F (mm)
100	134	39	19	98	126	M6×60	68
125	170,5	43,5	19	124	163	M8×70	79
160	210	44,5	19,5	157	200	M8×70	76

Tolerance: øA, B, C, F i øa: ±3 mm; D: ±3 mm.